



ASSEMBLY INSTRUCTION

SENNA MK2 FILING CABINET

ITEM CODE:54557

Imported by Super Amart Pty Ltd.Qld.Brisbane Australia.

For any assistance with assembly or for missing parts please phone

Super Amart Ewing Road,Customer Service Free call 1800 351 084

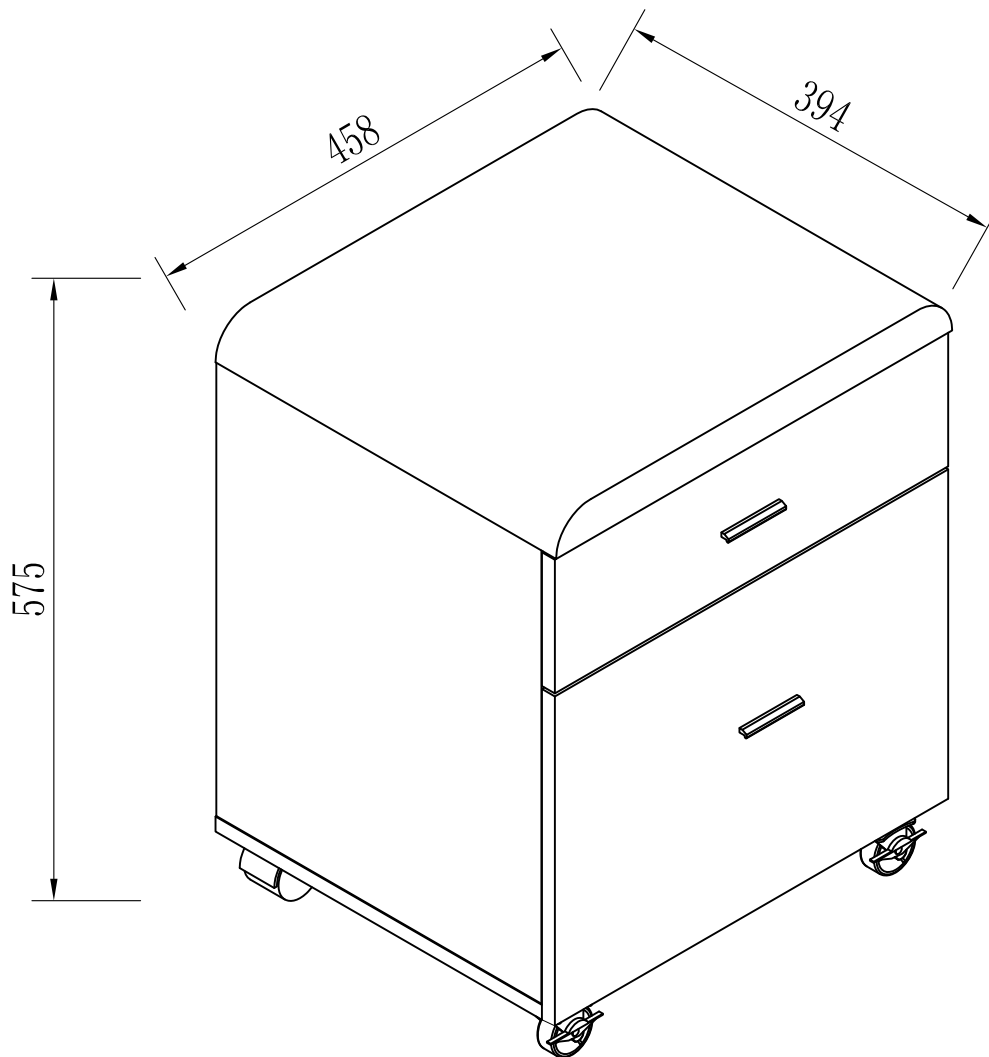



Imported by Super Amart Pty Ltd.Qld.Brisbane Australia.

For any assistance with assembly or for missing parts please phone Super Amart Ewing Road,Customer Service Free call 1800 351 084

PRE-ASSEMBLY PREPARATION

Before you start:

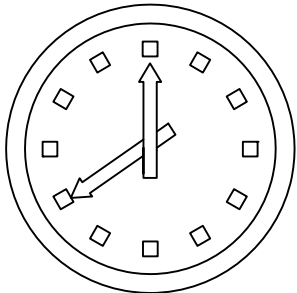
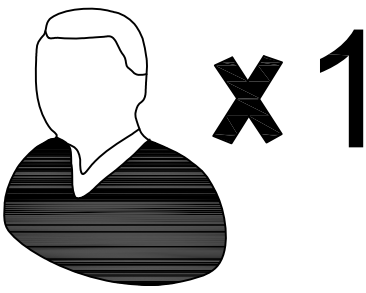
1. Choose a clean, level, spacious assembly area. Avoid hard surfaces that may damage the product
2. Take care when lifting. Product should be assembled as near as possible to the point of use
3. Ensure that you have all required contents for complete assembly.
4. Always read the assembly instructions carefully before beginning assembly.
5. Keep all hardware parts and packaging out of reach of small children.
6. Do not over tighten the screws and bolts as this may damage the threads

 ALLOW 40 MINUTES	 1 PEOPLE REQUIRED
 ⊕ ADDITIONAL TOOLS REQUIRED	

**WARNING**

Serious or fatal injuries may occur from furniture toppling over. To help avoid this please follow the below recommendations:

- Install the provided "Tipping Kit" as per the instructions
- Never allow children to climb on or hang off of any part of this product
- Unless specifically designed to accommodate, do not set TVs or other heavy objects on top of this product

If this product has drawers:

- Place the heaviest items in lowest drawers
- Do not open more than 1 drawer at a time as this may cause the product to become unbalanced
- Do not tamper with or remove any drawer interlocking/running system

Note: The use of the provided "Tipping Kit" may reduce but not necessarily eliminate the risk of furniture toppling over. Please use this product with caution.

This is a permanent label. Do not attempt to remove!

CAM Lock and Pins

step 1

HOW TO USE CAM LOCK FASTENERS

To assemble this product hardware called Cam Lock Fasteners are used.

The below is information on how these work.

Cam Locks are fasteners used to join two boards together, usually the edge of one board(A) to the flat side of another board(B)

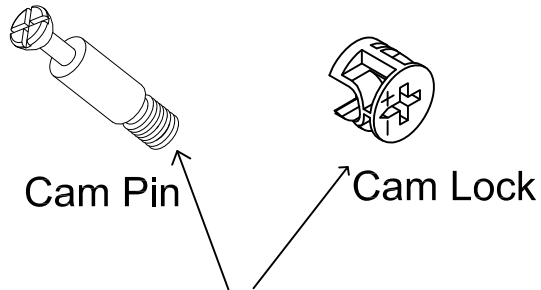

Ensure that you use the correct images that are representative of the hardware used in the product

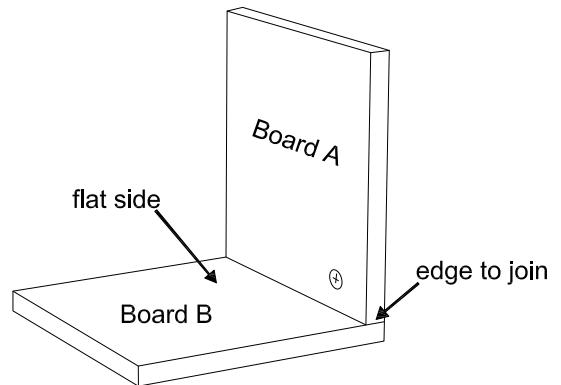

step 2

To use Cam Lock Fasteners

The Cam Pin is inserted into the flat side of a board, it is important that:

- * The cam pin is kept vertical and is not put in on an angle
- * Cam Pin is inserted up to the collar
 - * Too far and it won't catch the Cam Lock (Do not Over Tighten)
 - * Not enough and the resulting product won't be stable

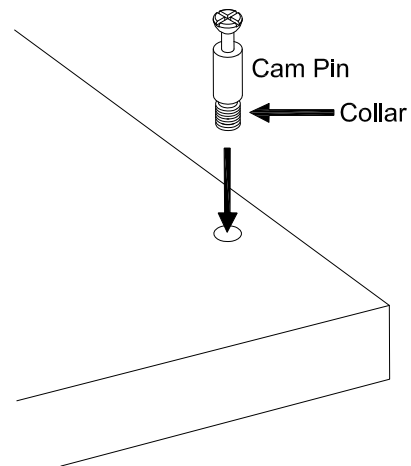

step 3

To use Cam Lock Fasteners

Now fit the hole in the edge of the joining board over the Cam Pin

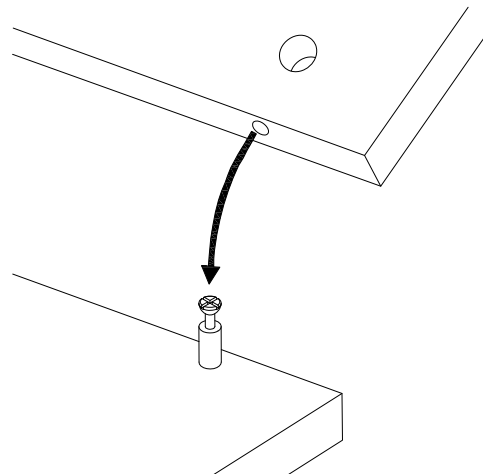

step 4

To use Cam Lock Fasteners

The Head of the Cam Pin will be visible in the large hole on the side of the joining board

head of the Cam Pin

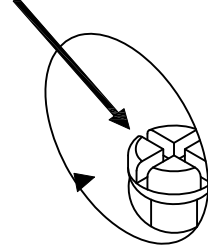

To use Cam Lock Fasteners

Notice the Cam Lock has a "C" Shaped back An Arrow or +/- signs on the front, indicated the open section on the back of the Cam Pin

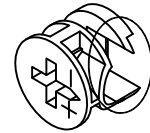

Cam Lock

step 5

To use Cam Lock Fasteners

In sert the Cam Lock into the large hole so the opening of the "C" fits over the head of the Cam Pin. You must ensure that the Cam Lock is pushed to the bottom of the hole to catch the top of the Cam Pin

Arrow or +/- signs

head of the Cam Pin

Open section of back fits over the head of the Cam Pin

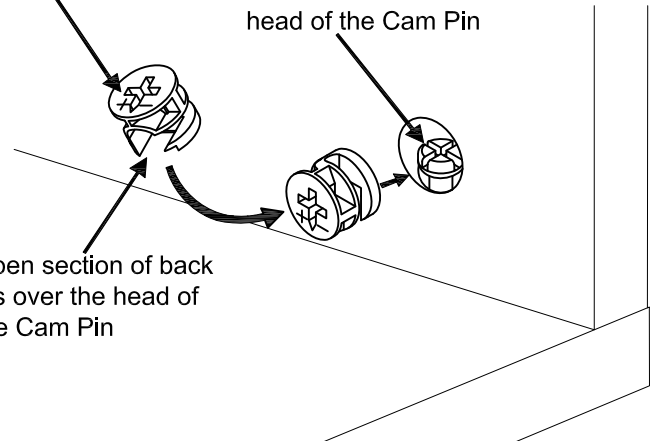

step 6

To use Cam Lock Fasteners

Use a flat screwdriver to turn the Cam Lock clockwise one half a turn so it Locks onto the head of the Cam Pin. Turn only until it is snug-over-tightening could cause the Cam to bend or break. If it will not turn the full amount, turn the Cam Pin out (counter-clockwise) one full turn, and try the Cam Lock again.

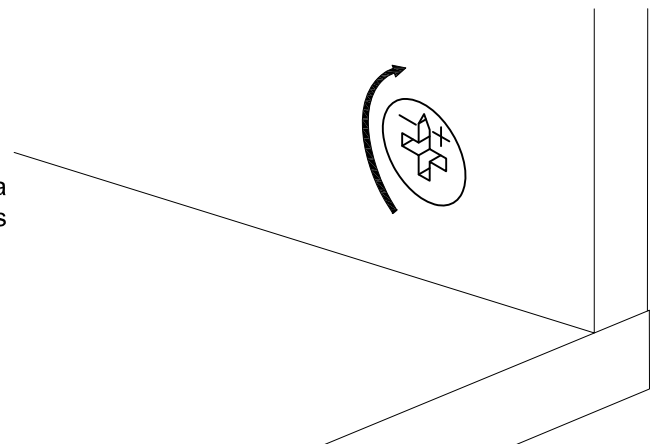

PARTS LIST

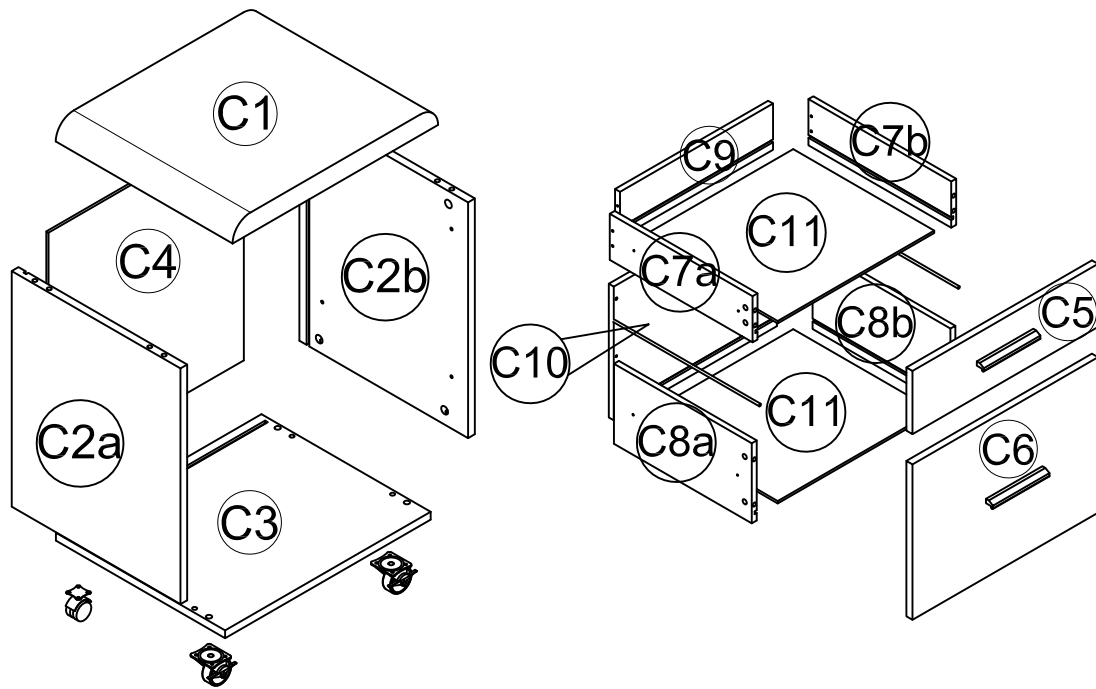

C1	TOP PANEL
C2a	LEFT SIDE PANEL
C2b	RIGHT SIDE PANEL
C3	BOTTOM PANEL
C4	BACK PANEL
C5	DRAWER FRONT PANEL
C6	DRAWER FRONT PANEL
C7a	DRAWER LEFT SIDE PANEL
C7b	DRAWER RIGHT SIDE PANEL
C8a	DRAWER LEFT SIDE PANEL
C8b	DRAWER RIGHT SIDE PANEL
C9	DRAWER BACK PANEL
C10	DRAWER BACK PANEL
C11	DRAWER BOTTOM PANEL

A. Cam lock and Cam pin Ø15X35 8PCS	B. Cam lock and Cam pin Ø12X27 8PCS	C. Dowel Ø8X30 8PCS	D. Wheel 2PCS	E. Screw Ø3.5X12 24PCS	F. Screw Ø3.5X30 8PCS	G. Screw Ø3.5X18 4PCS
H. Connector 4PCS	I. Bolt M4X20 4PCS	J. Handle 2PCS	K. Runner 350mm 4PCS	L. Hanger bar Ø5X358 2PCS	M. Wheel 2PCS	N. Screw Ø4X14 16PCS
O. Belt ø3.5x16 1PCE	P. Screw Ø3.5X16 2PCS					

54557

Step 1. Take off the Runner (K)to K1.K2

Runner slide separately($K=K1+K2$)

Carefully pull out the runner slide(K2)and press plastic clip to fully separate runner slide as diagram shown

$$K=K1 + K2$$

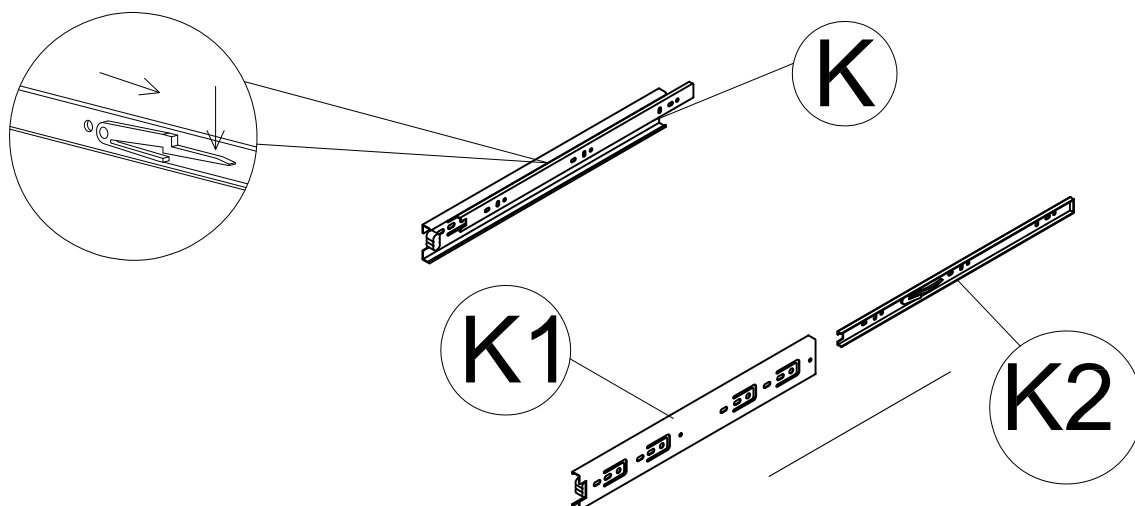

Step 2. Use a flat screwdriver to tighten Runner(K1) to Right side panel(C2b)and Left side panel(C2a)

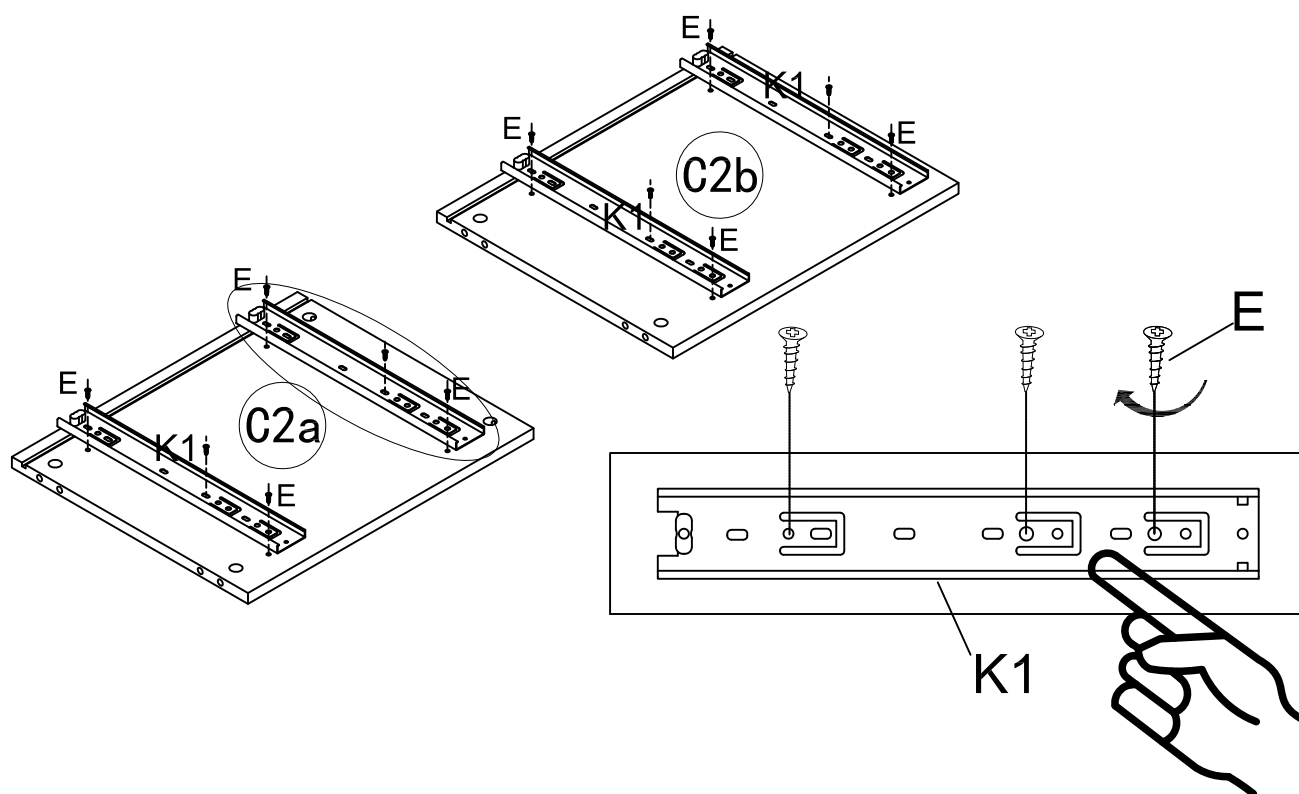

Step 3.Tighten Bottom panel(C3)to Left side panel(C2a)and Right side panel(C2b).Insert the Cam pin(A) to the Bottom panel(C3).Insert the Cam lock(A)in to the Left side panel(C2a)and Right side panel(C2b)large hole use a flat screwdriver to turn the Cam lock to locks onto the head of Cam pi n(A).

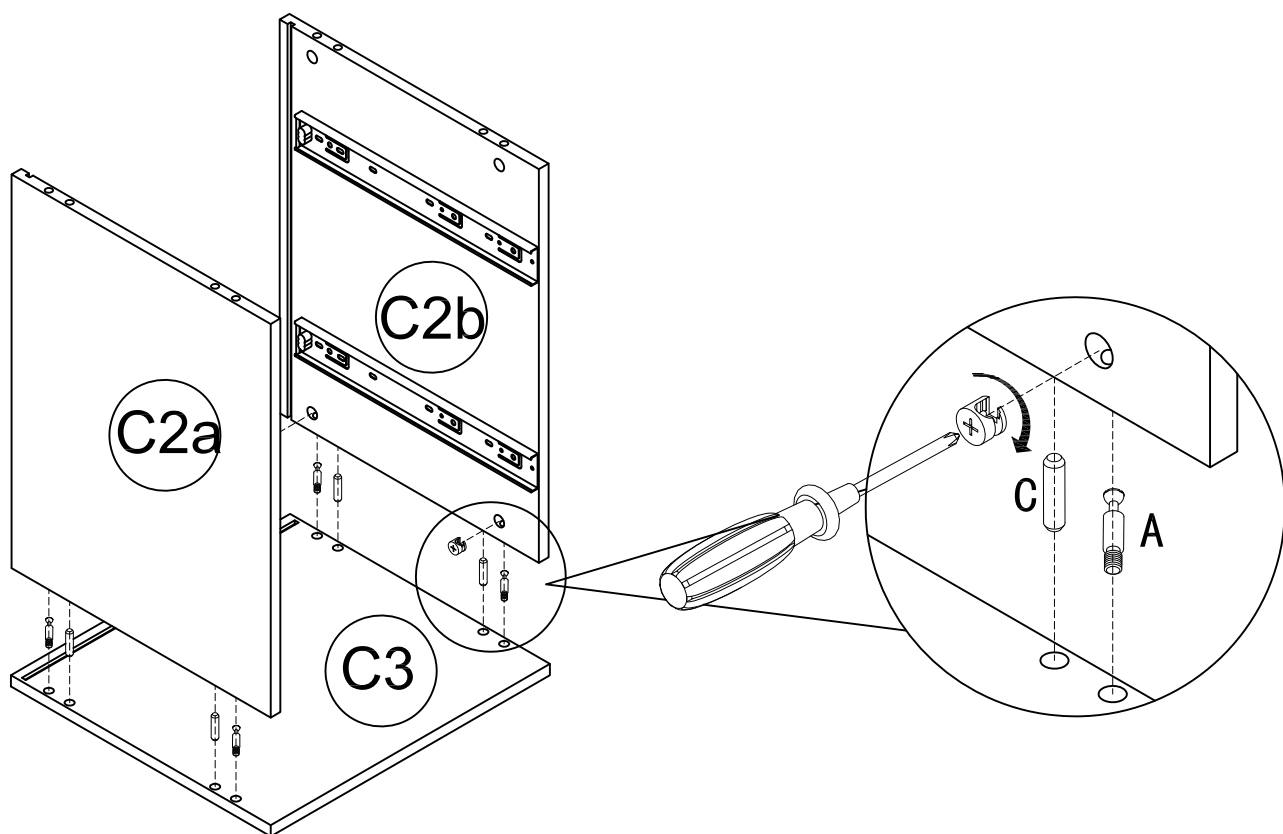

Step 4.Put down the Back panel(C4)in the Left side panel(C2a)and Right side panel(C2b)and Bottom panel(C3)

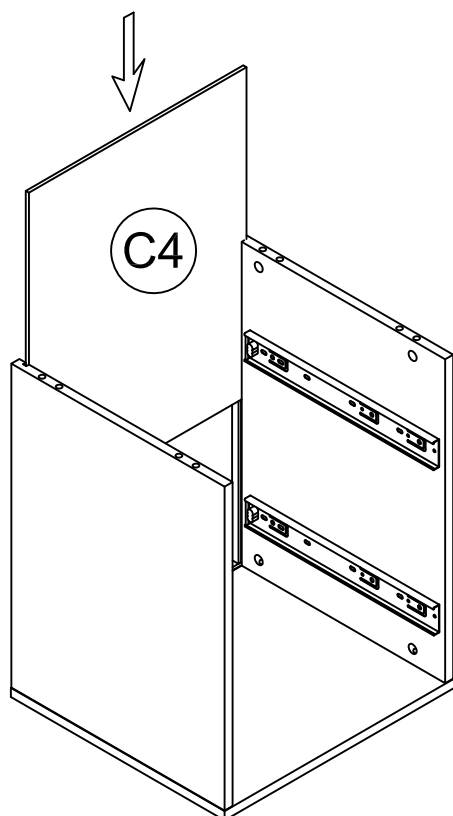

Step 5. Tighten Top panel(C1)to Left side panel(C2a)and Right side panel(C2b).Insert the Cam pin(A) to the Bottom panel(C3).Insert the Cam lock(A)in to the Left side panel(C2a)and Right side panel(C2b)large hole use a flat screwdriver to turn the Cam lock to locks onto the head of Cam pin(A).

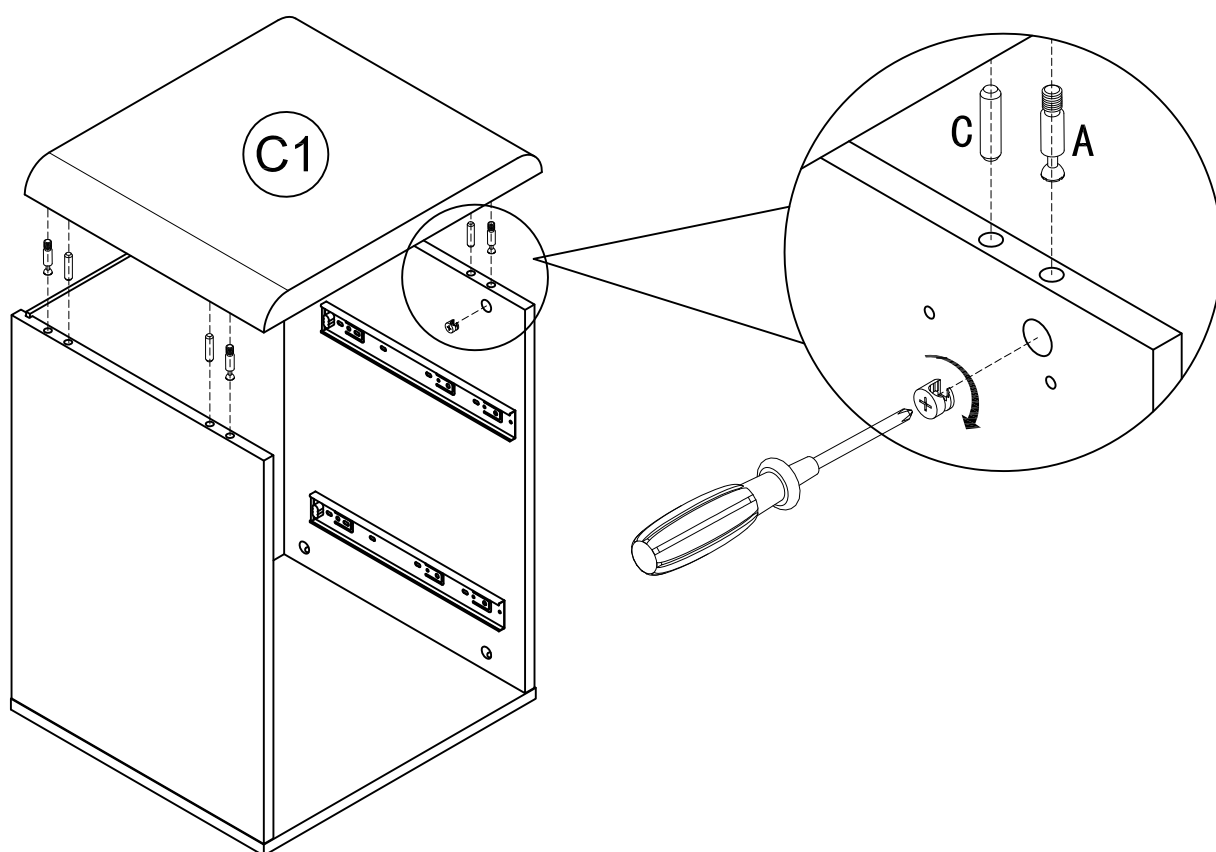

Step 6. Use a flat screwdriver to tighten Wheel(D.M) to Bottom panel(C3)with Screw(N) .

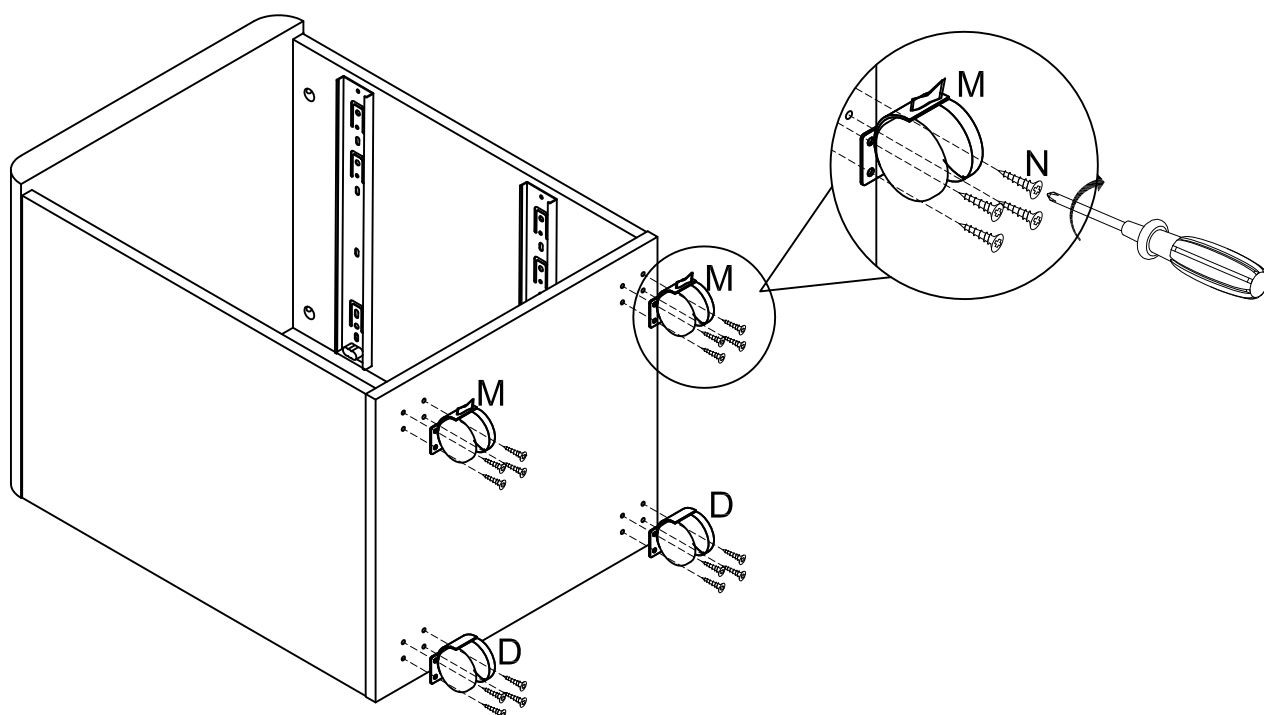

STEP 7: Use a Flat Head Screwdriver to tighten the Connector(H)to the corner of back with screw(G).Use a Flat Head Screwdriver to tighten the Belt(O)to the Top panel(C1) with Screw(O).

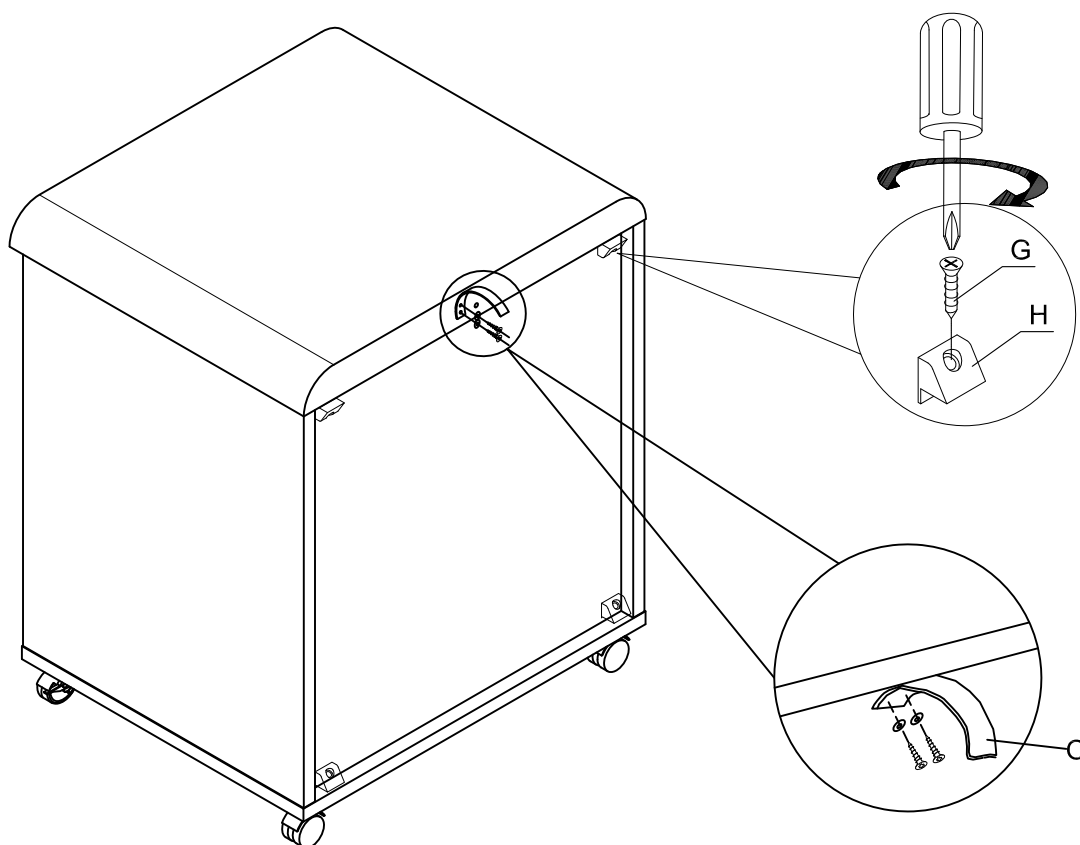

Step 8. Use a flat screwdriver to tighten Drawer side panel(C7a.C7b) to the Drawer back panel(C9). with Screws(F). Put on Drawer bottom panel(C11)to the Drawer side panel(C7a.C7b) and the Drawer back panel(C9). Tighten Cam pin(B) on the Drawer front panel(C5) .Insert the Cam lock(B)in to the Drawer side panel(C7a.C7b)large hole use a flat screwdriver to turn the Cam lock to locks onto the head of Cam pin.use a flat screwdriver to tighten Handle(J)on the Drawer front panel(C5)with Bolt(I)

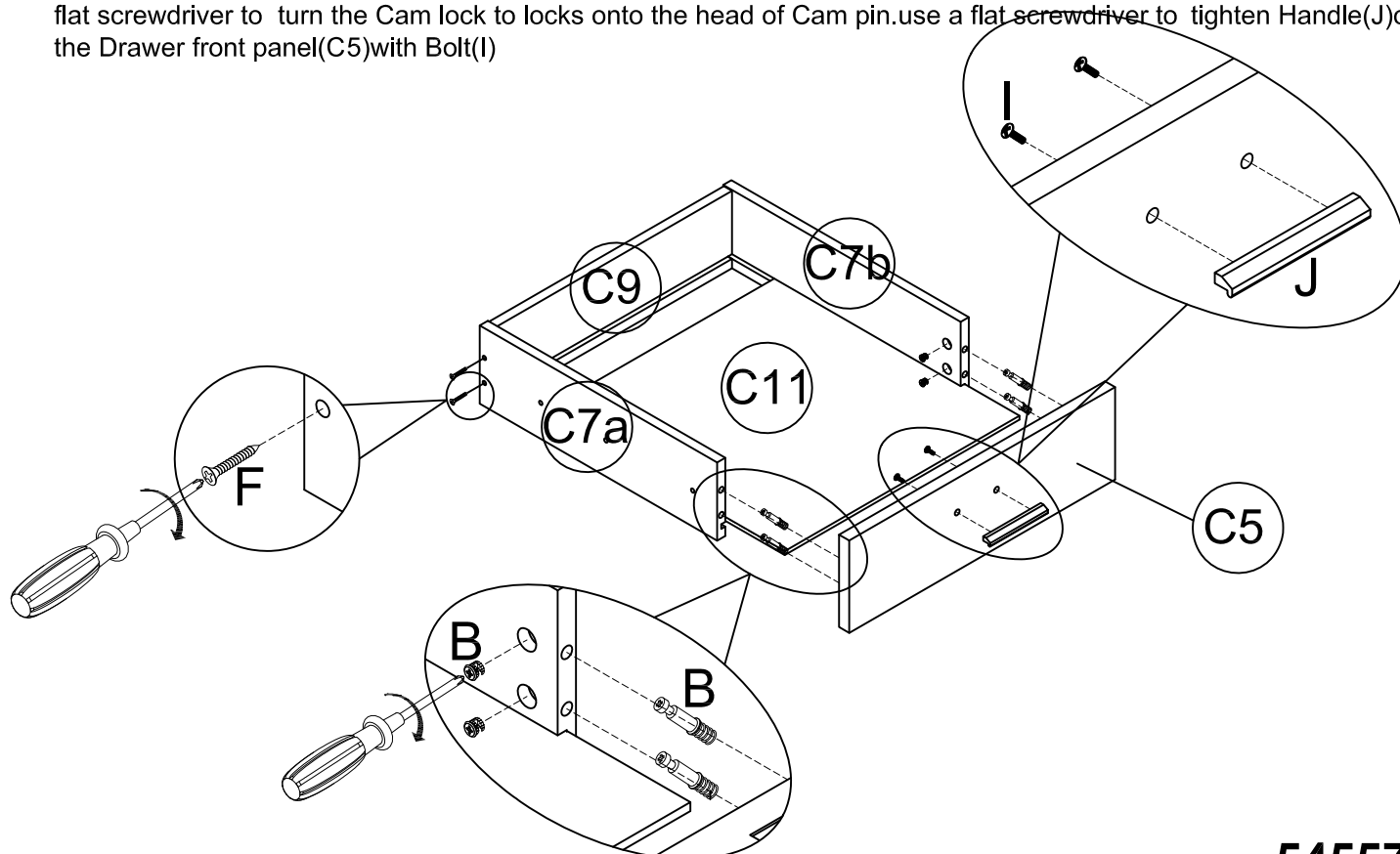

Step 9. Use a flat screwdriver to tighten Runner(K2) to Drawer side panel(C7a C7b)with Screw(E)

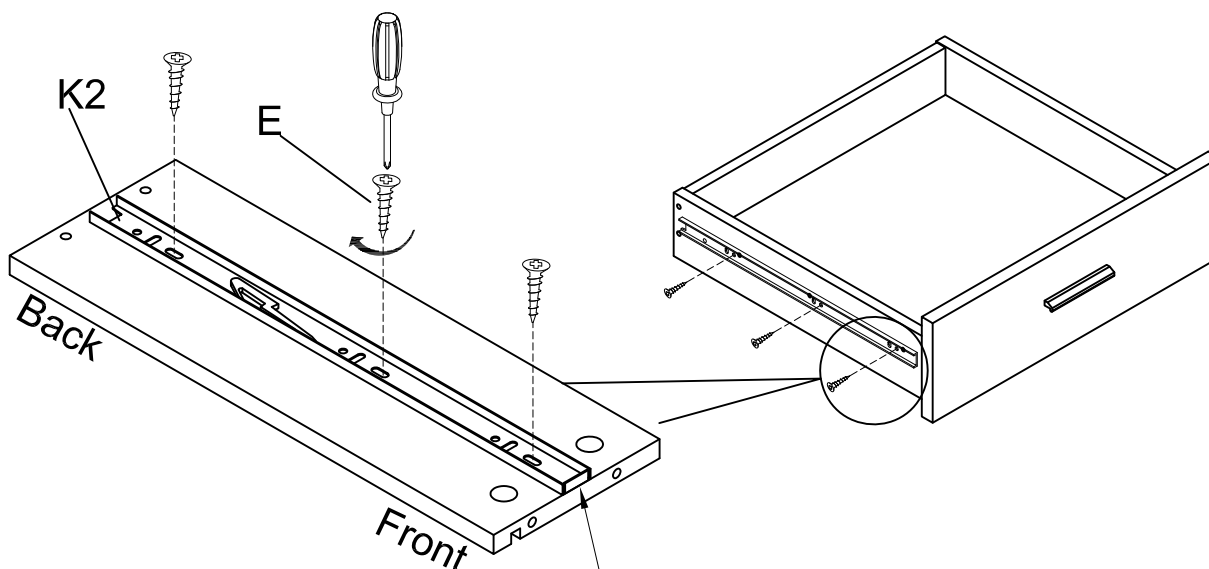

Runner slide must be flush with the drawer side panel edges during assembly step"

Step 10. Use a flat screwdriver to tighten Drawer side panel(C8a.C8b) to the Drawer back panel(C10). with Screws(F). Insert Hanger bar(L) in to Drawer back panel(C10)and Drawer front panel(C6). Put on Drawer bottom panel(C11)to the Drawer side panel(C8a.C8b) and the Drawer back panel(C10).Tighten Cam pin(B) on the Drawer front panel(C6) .Insert the Cam lock(B)in to the Drawer side panel(C8a.C8b)large hole use a flat screwdriver to turn the Cam lock to locks onto the head of Cam pin.use a flat screwdriver to tighten Handle(J)on the Drawer front panel(C6)with Bolt(I)

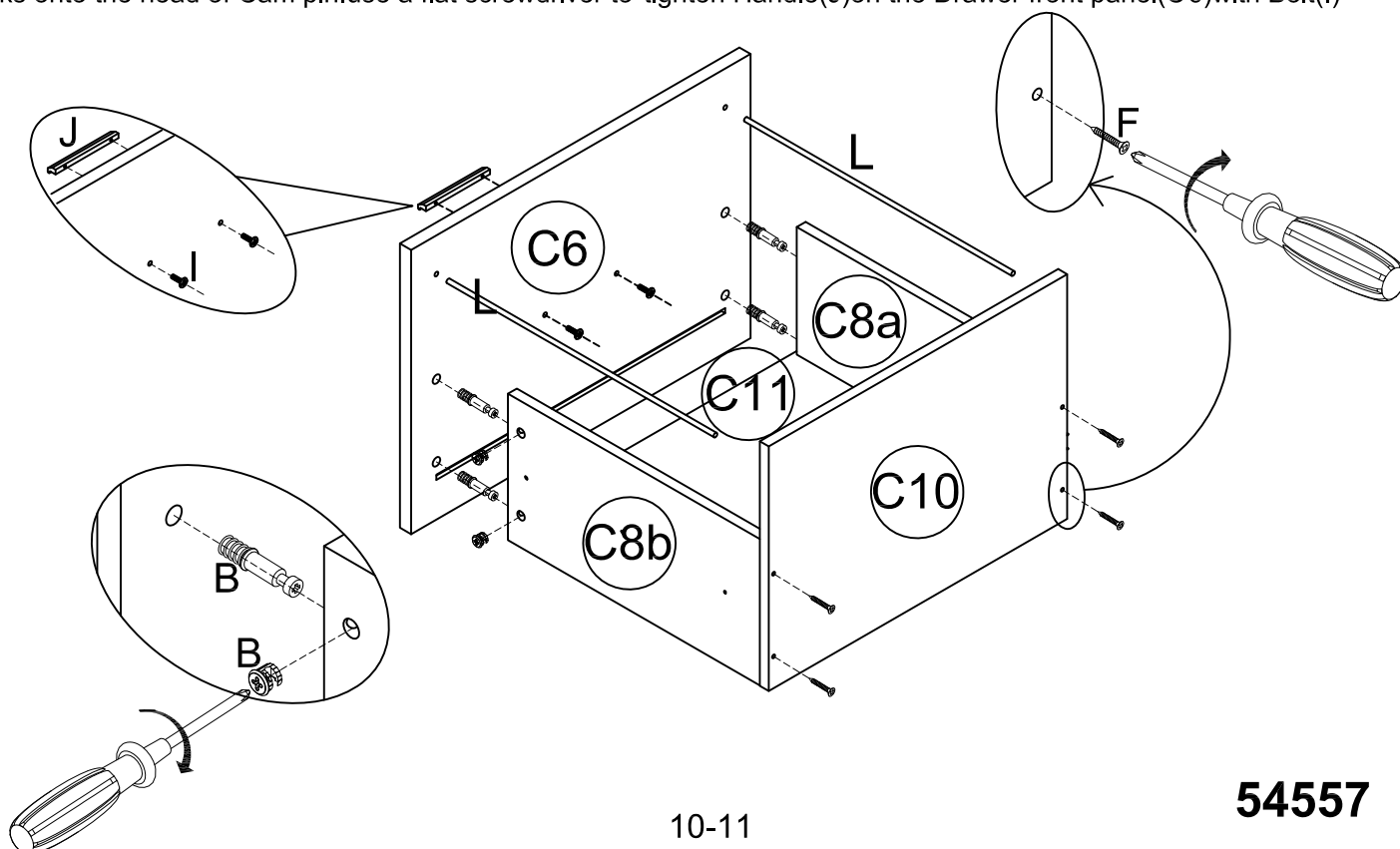

STEP 13: As an extra safety precaution please use the belt and screws(P) supplied to attach the unit securely to the wall.

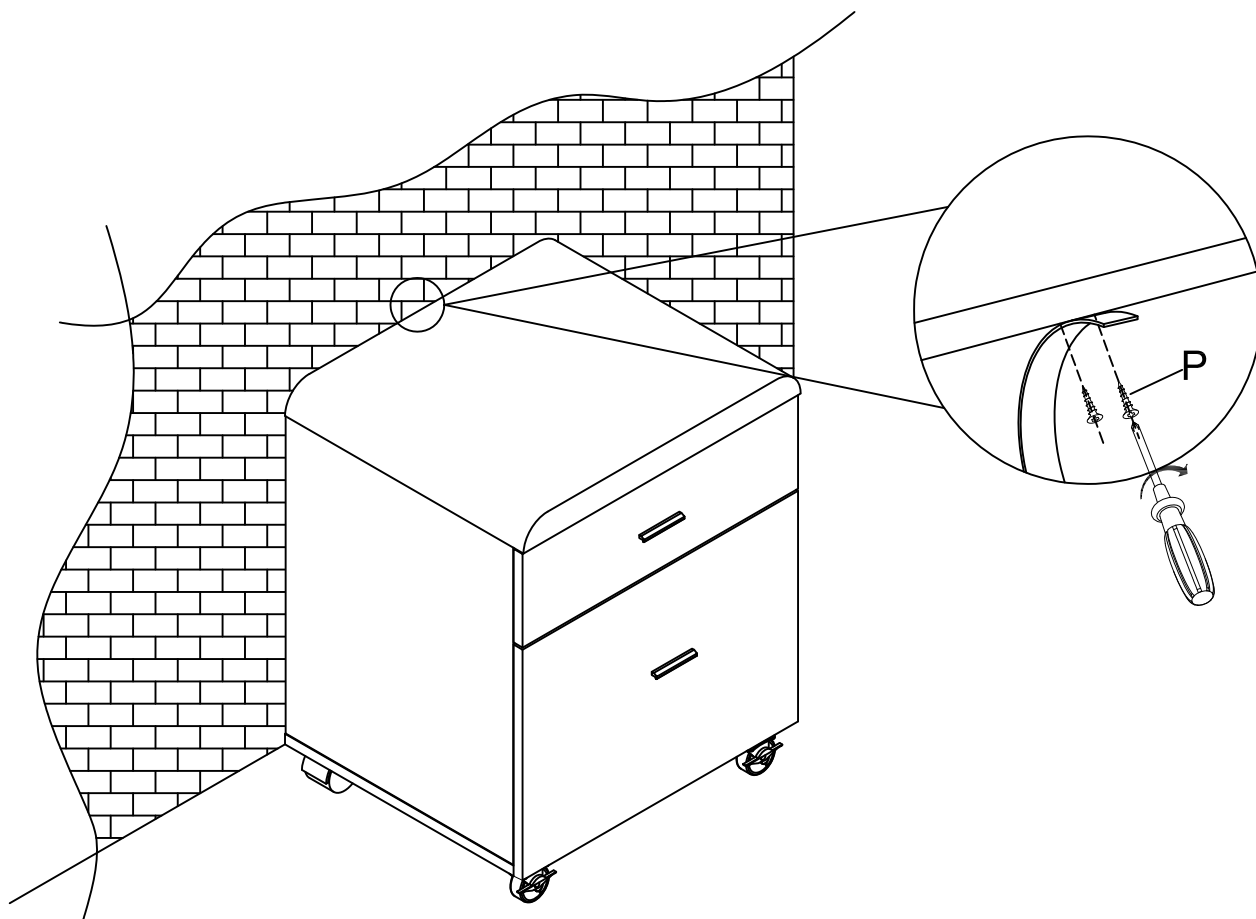

ASSEMBLY IS COMPLETE

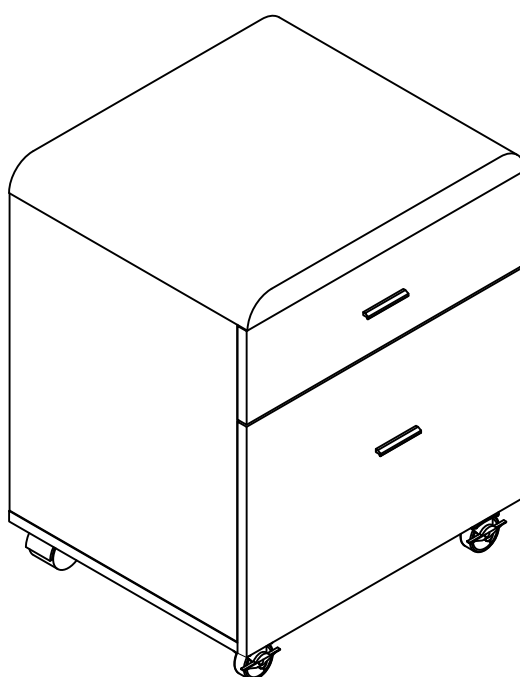

IMPORTANT: CARE GUIDE FOR YOUR HI-GLOSS FURNITURE

Congratulations! You have just purchased a quality product from Super Amart, Australia's largest discount furniture retail store. Please read on for important information regarding your purchase...

Hi-gloss lacquered furniture is more sensitive to marks and scratching than some other furniture products. It is important to exercise caution and care to maximise the life and beauty of this product.

Following the below simple guidelines when using your hi-gloss product will protect your investment for years to come:

- Dust frequently with a clean damp, lint-free cloth. This will help remove abrasive build up which can damage a finish over time.
- Avoid using chemicals or solvents when cleaning the product.
- Do not place hot objects on any furniture surface. Always use a hot plate or placemat. Lacquer finishes provide added scratch and heat resistance to our furniture, but they can still be damaged without proper care.
- Avoid exposing your furniture to strong sunlight. Prolonged exposure to direct sunlight can fade the finish of your furniture.
- Do not expose your furniture to any liquids. Avoid allowing water to sit on your furniture. Alcohol, nail polish and perfume are particularly harmful as they will dissolve the lacquer finish on contact.
- Do not allow plastic to come in direct contact with your furniture. Chemicals in the plastic of some placemats etc may soften and mark the finish if left in contact with the furniture for a period of time.
- Avoid placing sharp or rough objects on the surface of your furniture. These may scratch the surface of the product.
- When moving your furniture, do not drag it across the floor. This may damage the product. Instead use two people to lift carefully with caution from either end.



Warning:



Super Amart Furniture

Hi-gloss Furniture

Lacquered furniture is highly sensitive and conducive to marks and scratching. Please exercise extreme caution and care to maximize the life of this beautiful product.

1. Only use a warm damp cloth when cleaning furniture.
2. Do not use any chemicals or solvents.
3. Keep furniture away from direct sunlight or over heater vents as this may cause discoloring.
4. Do not place any hot items directly on the surface.
5. Do not place any sharp or rough objects on the surface.
6. Do not drag furniture. Use two people to lift carefully with caution from either end.